

FACADESTHREE IRONCLAD XI-SERIES STUCCO ASSEMBLY

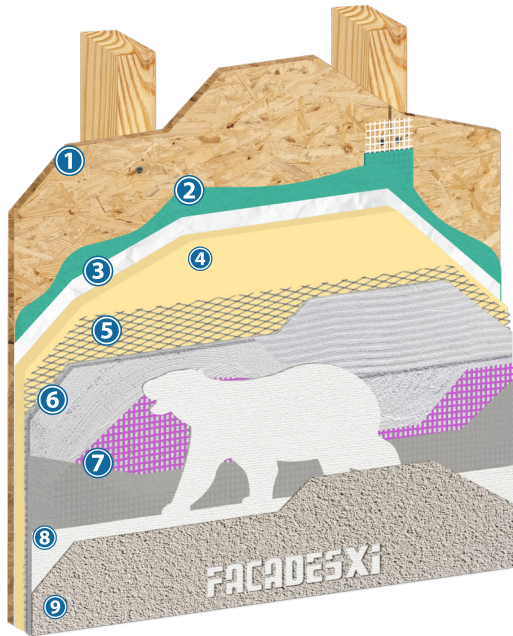

SYSTEM DESCRIPTION

FacadesThree IronClad Xi-Series is a traditional scratch and brown stucco wall assembly with the added protection of a seamless water and air barrier coating, FractureStop layers, and Xterior Insulation, complying with the International Building Code, International Residential Code and ASTM C926 in a warrantable assembly. It gives the maximum weather protection, energy efficiency, water drainage and resistance to cracking available on the market today with a single source and complete warranty available.

Optional Advantages Upgrades

- Drainage Mat for superior Drainage Efficiency
- FractureStop: Decrease the appearance of hairline cracks in the stucco surface.
- Strength Advantage: Xi-Admix
- Consistency Enhancement: Xi-Alkali Resistant Primer
- Elastomeric finish coat bridges hairline cracks

COMPONENTS

- Substrate**
 - ASTM C1177 glass mat faced sheathing
 - ASTM C79/C1396 exterior gypsum sheathing
 - ASTM C1325 Type A Exterior cement-board
 - Exposure I or exterior plywood sheathing (grade C-D or better)
 - Exposure I OSB
 - Poured concrete/unit masonry/brick
- WaterShield Water and Air Barrier Assembly**
 - WaterShield Water & Air Barrier
 - WaterShield Flashing Tape
 - WaterShield Joint Mesh
 - FXI FlashFill
- Means of Drainage**
 - Drainage Mat
 - Grooved Insulation Board
 - Polyolefin water barrier with internal means of drainage

Drainage plane is required in certain types of construction.
- Xi Continuous Insulation**
 - Expanded Polystyrene
 - Extruded Polystyrene
 - Polyisocyanurate
 - Mineral Wool
- Code compliant lath**
 - Metal Lath
 - Plastic Lath
- FacadesThree Scratch and Brown**
 - FacadesThree Concentrate: pre-mixed ASTM C926 code compliant stucco base coat consisting of portland cement, fibers and additives, mixed with water and sand
 - FacadesThree Sanded: pre-mixed ASTM C926 code compliant stucco base coat consisting of portland cement, sand, fibers and additives mixed only with water in the field
- FractureStop Layer**
 - Xi-Dry Acrylic Base Coat or Xi-Acrylic Base Coat
 - Xi-Mesh Standard Reinforcing Mesh
- Primer (Optional per specification) – for decreased efflorescence and highest finish coat aesthetic performance.**
 - Xi-Alkali Resistant Primer
 - Xi-FastPrime
- Finish Coat – Integrally colored and textured. Unlimited color selection, dirt pick up resistant**
 - Xi-Textured Acrylic Finish
 - Xi- Flexx Finish

Consult system specifications for exact component options.

USES

Exterior, interior, high impact requirement, new, retrofit, residential, multi-family, commercial, panelized, institutional, hotels, hospitals, retail centers, schools, condominiums, and government facilities

COMPLIANCE APPROVALS

FacadesThree is installed as a traditional three coat Scratch and Brown 7/8" thick base coat, complying with ASTM C926 when installed in compliance with the International Building Code/ International Residential Code.

Complies with Chapters 14 and 25 of the IBC and Chapter 7 of the IRC.

Non-combustible and Fire resistant assemblies are available

ADVANTAGES

- WaterShield provides an enhanced water and air barrier for envelope protection.
- Factory prepared mixed stucco base for consistent field quality control.
- Impact and puncture resistant.
- Highest quality acrylic and elastomeric finishes.
- EPS shapes for architectural details.
- Reduced Labor.
- Non-combustible and Fire resistant assemblies are available.
- Enhanced Warranty Available.
- R-Value for increased energy efficiency.
- FractureStop Layer increases water resistance and crack resistance.

DESIGN CONSIDERATIONS

- All products must be installed in accordance with current Product Datasheets.
- Maximum allowable deflection $L/360$.
- The design wind load shall be determined by the structural engineer.
- Load roofs and install interior gypsum prior to installation of the stucco.
- Wood-based sheathing should be gapped 1/8-inch.
- All penetrations shall be properly treated, flashed and/or sealed using approved installation designed for water drainage to the exterior of the wall.
- Control joint placement is every 144 ft².
- Expansion joints are per project design.
- Expansion joints should be installed at floor line, dissimilar substrates, and through wall expansion joints. Final expansion and control joint design and location are the responsibility of the design professional.
- Sealant joints shall be detailed and installed per sealant manufacturer's recommendations.
- Slope is required on all horizontal surfaces greater than 1".

LIMITATIONS

- Framed walls must terminate stucco a minimum of 4-inches above grade, 2-inches above finished grade, or as specified by local code.
- Moist curing must be provided per specifications.
- Ambient and surface temperature must remain above 40°F (4°C) during and for 24-hours after set has occurred.
- Protect applied product from inclement weather until dry.
- Efflorescence is a natural occurrence when using cement based products subject to exterior or wet environments.
- No additives are permitted to any components unless specifically approved by FXI.
- Follow the application instructions for each component.
- Cracking will occur in portland cement stucco. This statement is true of any Portland cement based product and is not a defect of the product. Cracking can be minimized by following the product datasheets and specifications including proper installation of lath, proper use of control and expansion joints, proper sand selection, proper proportioning of stucco mix, avoiding the use of excess water, moist curing of the stucco after it has been applied, and proper sequencing of construction to avoid stresses in the freshly placed stucco.
- Use only on surfaces that are sound, dry, clean, unpainted, and free from any residue that may affect the ability of the FACADESXI Products to bond.
- WaterShield should not be left exposed more than 6 months.
- Ensure Lath fasteners are secured into framing members.
- For use on vertical above grade walls only.
- Dark colors may show efflorescence more easily and imperfection in the stucco base coat compared to light colors.
- Maintenance Required: periodic cleaning, repair of cracks and impact damage if they occur, recoating to enhance appearance of weathered finish.

This system bulletin is not to be used as an application guide. See System specifications, details, and product datasheets for specific installation information.