

FACADESXI DIRECT APPLIED FINISH SYSTEMS

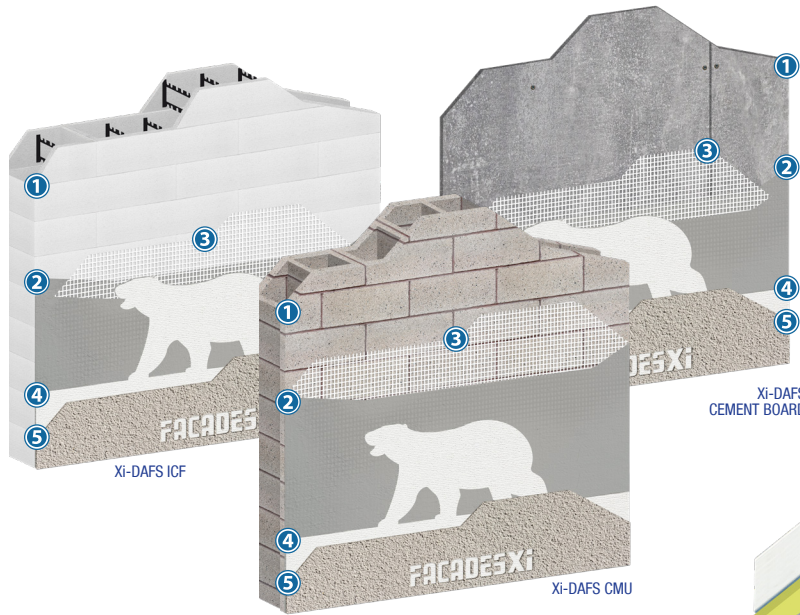

SYSTEM DESCRIPTION

Xi-DAFS are Direct-applied Finish Systems for use on ceilings and soffits, Concrete, CMU, ICF, Interior surfaces and screen walls. The areas must be protected from weather when applied directly to fiberglass faced exterior gypsum sheathing.

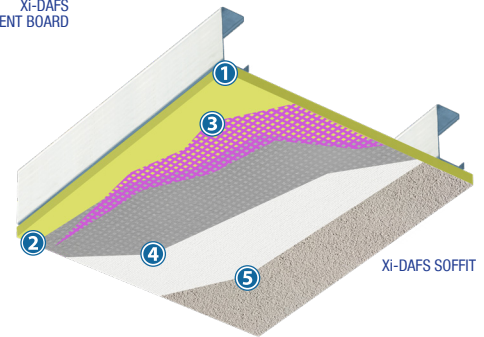

COMPONENTS

① Substrate

Protected Soffits

- ASTM C1177 glass mat faced sheathing
- ASTM C1325 Type A Exterior cement-board
- ASTM C931 Exterior Soffit Board

Exterior Walls

- Concrete
- Concrete masonry (CMU)
- Poured concrete
- Unpainted Brick
- ICF
- Foam Shapes on code compliant walls

Interior/Protected Walls

- ASTM C1177 glass mat faced sheathing
- ASTM C1325 Type A Exterior cement-board
- ASTM C79/C1396 gypsum sheathing

② Base Coat

- Xi-Acrylic Base Coat
- Xi-Dry Acrylic Base Coat

③ Reinforcing Mesh (Not required over CMU, Concrete, Brick)

- Xi-Mesh
- Xi-Mesh 6
- Xi-Mesh 12

④ Primer (Optional per specification) – for decreased efflorescence and highest finish coat aesthetic performance.

- Xi-Alkali Resistant Primer

⑤ Finish Coat – Integrally colored and textured. Unlimited color selection, dirt pick up resistant

Finish Coat – Integrally colored and textured. Unlimited color selection, dirt pick up resistant

Consult system specifications for exact component options.

USES

Xi-DAFS can be used for all types of wall or soffit assemblies that desire the durable and flexible stucco acrylic finish but do not require a full wall assembly; unpainted soffits, ceilings, insulated concrete forms, interior drywall, foam shapes, masonry, stucco, brick and concrete.

COMPLIANCE APPROVALS

The FACADESXI DAFS products have all been tested to ASTM E2568 / ICC Acceptance Criteria AC235 in accordance with the International Building Code / International Residential Code.

ADVANTAGES

- Eliminates Lath and Plaster on soffits
- Unlimited Finish Color and Texture Options
- Highest quality Acrylic and Elastomeric finishes.
- Durable Flexible Lamina for a protected wall.
- Shorter construction schedule
- Warrantable Assembly

DESIGN CONSIDERATIONS

- All products must be installed in accordance with current building code, specifications and product datasheets.
- Substrate must be clean and free of anything that will prevent the adhesion of the Xi-Base coat.
- For Painted and damaged surfaces, contact FXI Technical Services.
- Insulated Concrete Forms
 - Ties cannot be exposed.
 - Insulation board must conform to Type I EPS and be rasped per specifications.
 - An Additional layer of insulation board may be required to level walls, contact FacadesXi.
- All penetrations shall be properly treated, flashed and/or sealed using approved installation designed for water drainage to the exterior of the wall.
- Control joint placement is per the substrate manufacturer.
- Expansion joints are per project design.
- Sealant joints shall be detailed and installed per sealant manufacturer's recommendations.
- Slope is required on all horizontal surfaces greater than 1".

LIMITATIONS

- Ambient and surface temperature must remain above 40°F (4°C) during and for 24-hours after set has occurred.
- Protect applied product from inclement weather until dry.
- No additives are permitted to any components unless specifically approved by FXI.
- Follow the application instructions for each component.
- The substrate shall be free of oil, dust, dirt, form release agents, efflorescence, paint, sealers, moisture, and any other materials that prevent long term adhesion.
- Maintenance Required: periodic cleaning, repair of cracks and impact damage if they occur, recoating to enhance appearance of weathered finish.

This system bulletin is not to be used as an application guide, See System specifications, details, Design Handbook and product datasheets for specific installation information.

DAFS SB 01/22/2021